

## shower valves - Mio Thermostatic Shower

### Introduction

Beautiful lines and contrasting chrome and black define the Mio range. Make a bold statement in the shower with this elegant bar shower mixer with its stylish range of accessories. Create the bathroom look you really want with the peace of mind that goes with thermostatic protection.

gives  
**total control**

- Suitable for use with unvented supplies, combi boilers, gravity and mains pressure systems
- Thermal cartridge technology
- Temperature stability of  $\pm 2^{\circ}\text{C}$
- Fail safe on hot and cold supplies
- Safe touch body
- Operating pressure range of 0.4 to 5 bar
- Integrated flow diverter
- Telescopic and fixed risers options available



### Product Range

Description	Code
mio thermostatic bar shower with fixed riser, overhead soaker and sliding handset	MI20012CP
mio thermostatic bar shower with telescopic riser, overhead soaker and sliding handset	MI20011CP

mio safe touch  
thermostatic bar shower  
with fixed riser, overhead  
soaker and sliding handset  
MI20012CP

mio safe touch  
thermostatic bar shower  
with telescopic riser, overhead  
soaker and sliding handset  
MI20011CP



## shower valves - Mio Thermostatic Shower

### Features

#### Technical Specification

Max Inlet Pressure static	5 Bar
Min Inlet Pressure dynamic	0.4 Bar
Max Inlet Temperature	85°C
Factory Pre-set Temperature	38°C with max temp stop
Inlet Connections	G 3/4" F BSP (valve body)
Outlet Connections	G 3/4" F BSP (top) G 1/2" F BSP (bottom)
Min Temperature to achieve hot or cold failsafe	15°C
System Installation	Unvented, Pressurised, Gravity and Combination Boilers

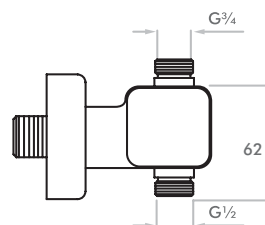
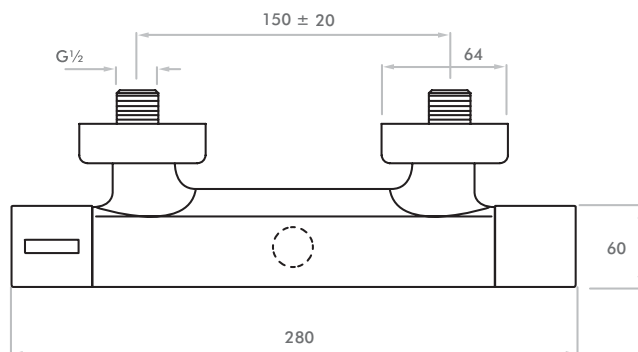
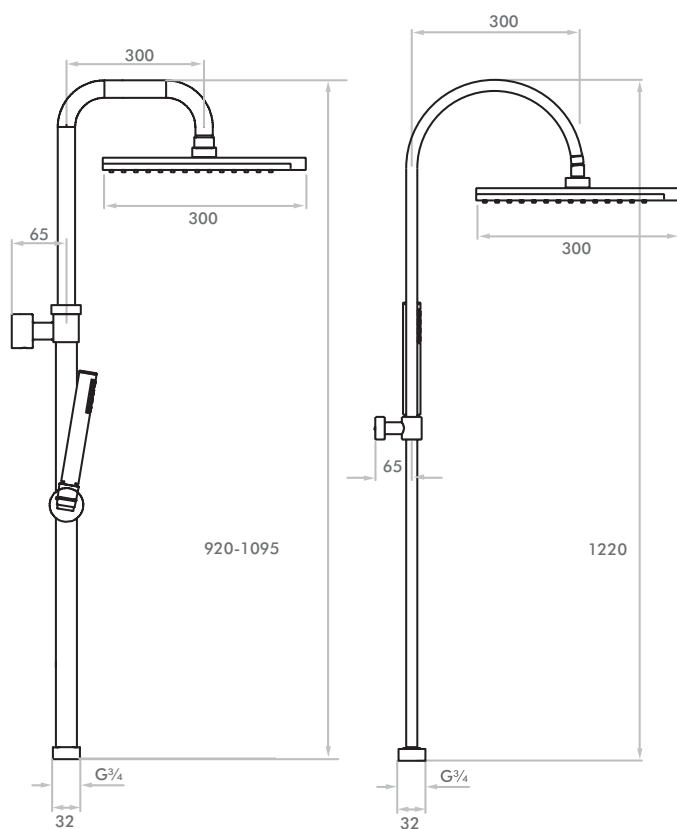

inspiring confidence

# inta